

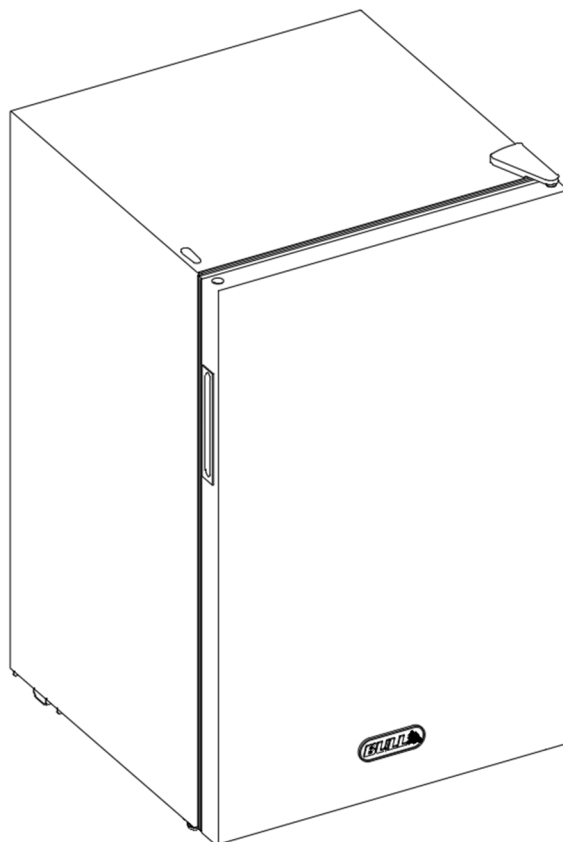

SELECT CONTEMPORARY REFRIGERATOR
OWNER MANUAL
MODEL #11520



USA EDITION



TABLE OF CONTENTS

PAGE#

APPLIANCE SAFETY AND IMPORTANT SAFEGUARDS.....2
 ELECTRICAL REQUIREMENTS / EXTENSION CORD REQUIREMENTS.....3
INSTALLATION INSTRUCTIONS
 LOCATION GUIDELINES.....4
 VENTILATION.....4
 LEVELING.....4
CHANGING THE DOOR SWING DIRECTION..... 5-6
OPERATION GUIDELINES
 SETTING THE TEMPERATURE CONTROL.....6
 ELECTRICAL.....6
 STORING FOODS.....6
ROUTINE MAINTENANCE
 AUTOMATIC DEFROSTING OF THE REFRIGERATOR.....7
 CLEANING THE UNIT.....7
 POWER FAILURE.....7
 VACATION TIME.....7
 MOVING YOUR UNIT.....7
 ENERGY SAVING TIPS.....7
TROUBLESHOOTING.....8
PRODUCT REGISTRATION, REPLACEMENT PARTS ORDERING INSTRUCTIONS.....9
REPLACEMENT PARTS LIST WITH EXPLODED ILLUSTRATION.....10
WARRANTY POLICY.....11-13

- READ THE FOLLOWING INSTRUCTIONS CAREFULLY AND BE SURE YOUR REFRIGERATOR IS PROPERLY INSTALLED, ASSEMBLED AND CARED FOR. FAILURE TO FOLLOW THESE INSTRUCTIONS MAY RESULT IN SERIOUS BODILY INJURY AND/OR PROPERTY DAMAGE. IF YOU HAVE QUESTIONS CONCERNING ASSEMBLY OR OPERATION, CONSULT YOUR DEALER OR APPLIANCE SERVICE REPRESENTATIVE.

- NOTE TO INSTALLER:
 LEAVE THESE INSTRUCTIONS WITH THE CONSUMER AFTER INSTALLATION.

- NOTE TO THE CONSUMER:
 RETAIN THESE INSTRUCTIONS FOR FUTURE REFERENCE.

- THIS REFRIGERATOR IS INTENDED FOR STORING BEVERAGES AND FRESH FOODS AT TEMPERATURES HIGHER THAN 0°C/32°F.

*FOR WARRANTY PURPOSES, PLEASE RECORD YOUR SERIAL NUMBER, DATE OF PURCHASE & A COPY OF YOUR RECEIPT OR INVOICE IN YOUR MANUAL ON PAGE 9.

WARNING: THIS PRODUCT CAN EXPOSE YOU TO CHEMICALS INCLUDING CARBON MONOXIDE, WHICH IS KNOWN TO THE STATE OF CALIFORNIA TO CAUSE BIRTH DEFECTS OR OTHER REPRODUCTIVE HARM. FOR MORE INFORMATION VISIT www.P65Warnings.ca.gov

BEFORE INSTALLATION OR USE, PLEASE READ AND FOLLOW ALL SAFETY RULES AND OPERATING INSTRUCTIONS



APPLIANCE SAFETY AND IMPORTANT SAFEGUARDS

READ CAREFULLY BEFORE OPERATION OF YOUR REFRIGERATOR

APPLIANCE SAFETY

Your safety and the safety of others is very important.
We have provided many safety messages in this manual and on your refrigerator. Always read and obey all safety messages.



This is the Safety Alert Symbol. This symbol alerts you to potential hazards that can injure or kill you and others. All safety messages will follow the Safety Alert Symbol with the word 'DANGER' or 'WARNING'



'DANGER' means that failure to heed this safety statement may result in severe personal injury or death.

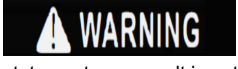

'WARNING' means that failure to heed this safety statement may result in extensive product damage, severe personal injury, or death. All safety messages will alert you about the potential hazard, tell you how to reduce the chance for injury and let you know what can happen if the instructions are not followed.

CHILD SAFETY



RISK OF CHILD ENTRAPMENT

Child entrapment and suffocation are not problems of the past. Junked or abandoned appliances are still dangerous, so please do the following before discarding your old refrigerator:

- 1) Take off the doors or drawers.
- 2) Leave shelves in place so children may not easily climb inside.
- 3) Never allow children to operate, play with, or climb inside the refrigerator.

PROPER DISPOSAL:

Before you throw away your refrigerator:
Please take off the door so that children cannot easily climb in and be trapped.

IMPORTANT SAFEGUARDS



Before the refrigerator is used, it must be properly positioned and installed as described in this manual, so read the manual carefully to reduce the risk of fire, electrical shock or injury when using the appliance by following the basic precautions below:

- Do not put your hands under the unit when the unit is required to be moved.
- Do not store or use gasoline or other liquids with flammable vapors in the vicinity of the or any other appliance that can create a fire or explosion hazard.
- Do not attempt to repair or replace any part of your refrigerator unless it is specifically recommended in this manual. All other servicing should be referred to a qualified technician.
- When the unit is not in use for a long period of time, please unplug the unit from the outlet.
- After unplugging the unit, wait at least 10 minutes before re-plugging it. Failure to do so could cause damage to the compressor.
- Do not defrost the appliance with other electric appliances (for example a hair dryer) and never attempt to scrape/remove ice/frost with sharp objects.
- **During maintenance and cleaning, please unplug the unit.**
- Never clean refrigerator parts with flammable fluids. The fumes can create a fire hazard or explosion.
- The refrigerator must be installed with all electrical connections in accordance with state and local codes. A standard electrical supply (115VAC only, 60Hz), properly grounded in accordance with the National Electrical Code and ordinances is required.
- Do not use solvent-based cleaning agents or abrasives on the interior. These cleaners may damage or discolor the interior.
 - Do not attempt to remove or repair any component unless instructed by factory.
 - Make sure that the unit is not resting on or against the electrical cord and plug.
 - To minimize personal injury, do not hang on the door.
 - Do not store any flammable and explosive gas or liquids inside the unit.
 - Do not attempt to alter or tamper with the electrical cord.

ELECTROCUTION HAZARD



Electrical Grounding Required

- 1) To minimize shock and fire hazards, make sure that the unit is properly grounded.
 - It is recommended your Refrigerator be powered by a separate circuit dedicated only to your appliance to minimize shock and fire hazards, be sure not to overload outlet. Please designate one outlet for your unit and that cannot be turned off by a switch or pull chain. The fuse or circuit breaker size should be 15 amps.
 - This appliance is equipped with a 3 prong (grounding) polarized plug and must be plugged into a 3 prong outlet for your protection against possible shock hazards.
- Where a 2 prong wall receptacle is encountered or a longer power cord is required, contact a qualified electrician to have it replaced in accordance with applicable electrical codes.**
- NEVER remove the grounding prong from the plug.
 - NEVER use a 2 prong grounding adapter.
 - NEVER use an extension cord connect power to the unit
 - Use a receptacle that cannot be turned off by a switch or pull-chain.
 - Do not connect or disconnect the electric plug when your hands are wet
 - Unplug the refrigerator or disconnect power before cleaning or servicing. Failure to do so can result in electrical shock or death.
 - Never clean Electrical cord for Refrigerator s with flammable liquids. These liquids have fumes that can create a fire or explosion hazard.



ELECTRICAL REQUIREMENTS



Improper use of the grounded plug can result in the risk of electrical shock. If the power cord is damaged, have it replaced by a qualified electrician or an authorized service center.

This appliance should be properly grounded for your safety. The power cord of this appliance is equipped with a three-prong plug which mates with standard three-prong wall outlets to minimize the possibility of electrical shock.

Do not under any circumstances cut or remove the third (ground) prong from the power cord supplied. For personal safety, this appliance must be properly grounded. Any questions concerning power and/or grounding should be directed toward a certified electrician or an authorized service center.

This appliance requires a standard 115/120 Volt AC ~60Hz three-prong grounded electrical outlet. Have the wall outlet and circuit checked by a qualified electrician to make sure the outlet is properly grounded. When a standard 2-prong wall outlet is encountered, it is your responsibility and obligation to have it replaced with a properly grounded 3-prong wall outlet.

To prevent accidental injury, the cord should be secured behind the appliance and not left exposed or dangling.

The appliance should always be plugged into its own individual electrical outlet which has a voltage rating that matches the rating label on the appliance. This provides the best performance and also prevents overloading house wiring circuits that could cause a fire hazard from overheating. Never unplug the appliance by pulling on the power cord. Always grip the plug firmly and pull straight out from the receptacle. Repair or replace immediately all power cords that have become frayed or otherwise damaged. Do not use a cord that shows cracks or abrasion damage along its length or at either end. When moving the appliance, be careful not to damage the power cord.

EXTENSION CORD

Because of potential safety hazards under certain conditions, it is strongly recommended that you do not use an extension cord with this appliance. However, if you must use an extension cord it is absolutely necessary that it be a UL/CUL-Listed, 3-wire grounding type appliance extension cord having a grounding type plug and outlet and that the electrical rating of the cord be 115 volts and at least 1.3 amperes.



INSTALLATION INSTRUCTIONS **READ CAREFULLY BEFORE INSTALLATION OF YOUR REFRIGERATOR**

GUIDELINES FOR SETTING UP YOUR REFRIGERATOR

**THE REFRIGERATOR MUST BE INSTALLED ACCORDING YOUR LOCAL CODES AND ORDINANCES.
BEFORE INSTALLING YOUR APPLIANCE**

- 1) Remove the exterior and interior packing.
- 2) Before connecting the refrigerator to the power source, let it stand for approximately 24 hours. This will reduce the possibility of a malfunction in the cooling system from handling during transportation.
- 3) Clean the interior surface with lukewarm water using a soft cloth.

LOCATION SELECTION

- 1) Your refrigerator has been designed for built-in or free standing use.
- 2) The location should be on a flat, level surface, preferably a dedicated floor. **DO NOT** set up on bare ground.
- 3) Do not install in a location where the temperature will be below 50 degrees Fahrenheit, or in a moist area

! REASONS WHY THESE LOCATION GUIDELINES ARE IMPORTANT

- 1) Install the unit on a strong and level surface, otherwise:
 - Unit may make unpleasant noises.
 - Unit may malfunction.
- 2) Install the unit in a dry, well-ventilated area.
- 3) Avoid locations that will expose unit to:
 - Direct sunlight
 - Prolonged temperatures below (32°F- 0°C) may also cause the unit not to perform properly.
 - Prolonged temperatures above (90°F- 32°C) will cause the compressor to overwork, leading to higher energy bills and gradual breakdown of the unit.
 - Avoid installation in a high humidity and/or dusty area.
 - Humidity which could cause unit to rust and decrease efficiency of the unit.
 - Excessive Dust that if allowed to collect on condenser coil will cause unit to malfunction. Clean the condenser at least once a month with a brush or clean cloth.
 - Heat emitting devices (for example cooking appliances, radiators, water heaters, or similar devices) and moisture-generating equipment.

VENTILATION

- 1) The unit must have more than 4 inches of clearance from the back of the unit to any walls for ventilation purposes. Also make sure there is nothing stuck underneath the unit.
- 2) No air space is required for the bottom, side or top

LEVELING YOUR REFRIGERATOR

Your Refrigerator has 2 adjustable feet on the bottom.

Do not operate your Refrigerator without them.

They serve two important roles:

- a. They are used to level your refrigerator.
- b. They provide a gap below the refrigerator allowing air flow.

Rotate the adjusting feet clockwise to decrease height, or counter clockwise to increase height.

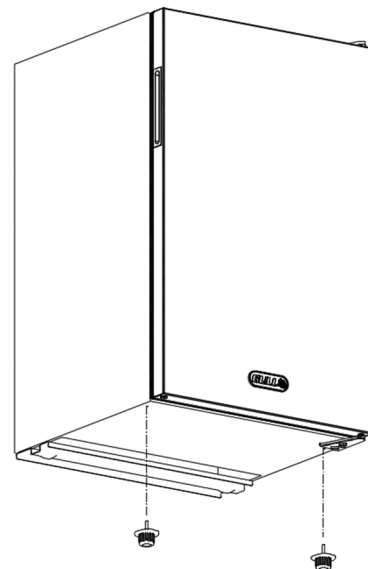
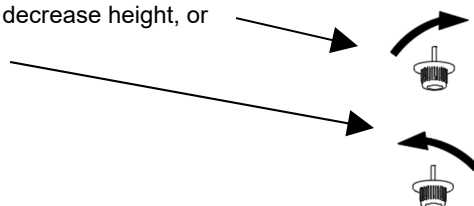



CHANGING THE DOOR SWING DIRECTION

Please follow the directions below to switch your door's swing direction.

First. Remove the contents from the unit, and the door. This will help prevent unintended messes from something falling over or out of the door during the switch. Now you're ready to begin.

Follow the steps below to switching the hinges.

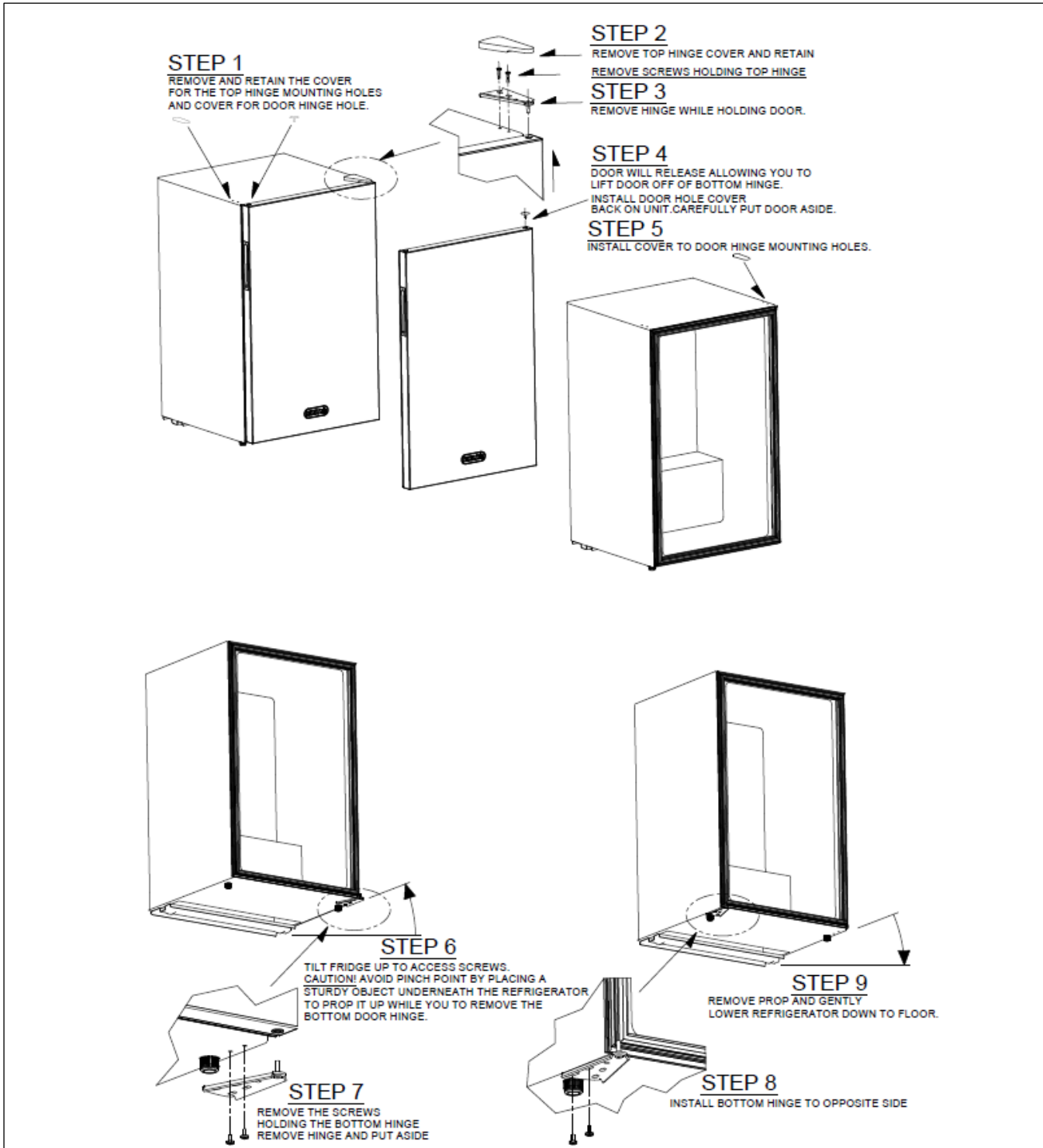



CHANGING THE DOOR SWING DIRECTION (CONTINUED)

Complete these remaining steps and you'll be ready to reload your refrigerator.

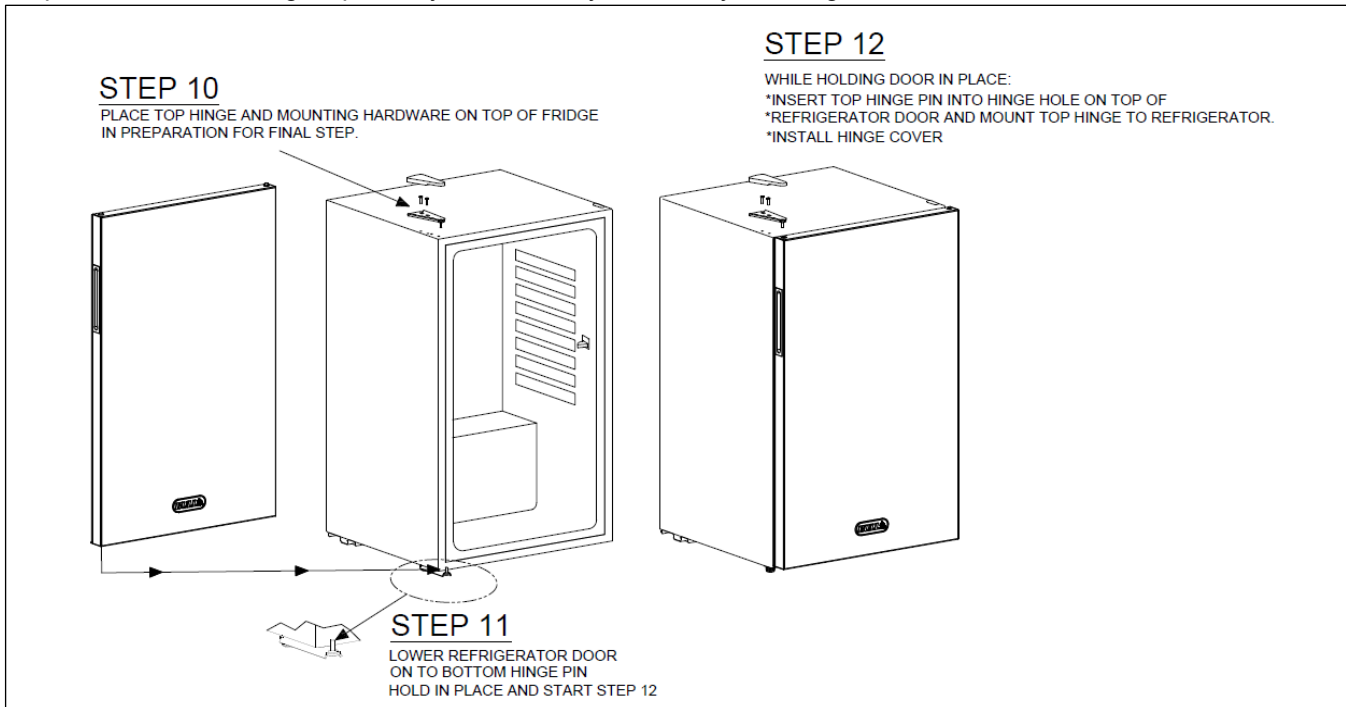

Great job! Door Swing change is now complete, and you can return the items you removed from the Refrigerator. Before using, please keep reading to understand all safety instructions in this manual and the manual included with your Refrigerator before use.

OPERATION GUIDELINES

SETTING THE TEMPERATURE CONTROL

- 1) Your unit has only one control for regulating the temperature in the compartment. The temperature control is located on the upper right-hand side of the compartment.
- 2) The first time you turn the unit on, set the temperature control to "6".
- 3) The range of the temperature control is from position "OFF" to "6". After 24 to 48 hours, adjust the temperature control to the setting that best suits your needs. The setting of "3" should be appropriate for home or office use.
- 4) To turn the appliance off, turn the temperature control to "OFF".

NOTE: Turning the temperature control to "OFF" position stops the cooling cycle but does not shut off the power to the unit. If the unit is unplugged, has lost power, or is turned off, you must wait 3 to 5 minutes before restarting the unit. If you attempt to restart before this time delay, the unit will not start.

ELECTRICAL

Please ensure that the required voltage of the compressor is always being supplied. Low or high voltage can detrimentally affect the refrigeration unit. All units should be plugged into a grounded and properly-sized electrical outlet with appropriate overcurrent protection. Please refer to the electrical requirements on the nameplate. Please make sure that your unit has its own dedicated outlet. Do not use an extension cord.

STORING FOODS

- 1) Foods to be stored in the refrigerator should be properly packed to prevent mixing various moisture degrees and odors.
- 2) Make sure that foods do not touch each other. Assure adequate air circulation around packages.
- 3) Never store flammable, volatile, or explosive substances.
- 4) Beverages with a high alcohol percentage shall be stored in tightly sealed bottles in a vertical position.
- 5) Food should not touch the rear wall of the refrigerator.
- 6) Try not to open the door too often.
- 7) Make sure to remove perishable articles of food out of the appliance before you leave for a long time.



ROUTINE MAINTENANCE

DISCONNECT POWER CORD BEFORE CLEANING ANY PARTS OF THE UNIT

AUTOMATIC DEFOSTING OF THE REFRIGERATOR

- 1) There is no need to defrost the refrigerator; ice depositing on the inner back wall is defrosted automatically.
- 2) Ice build-up on the inner back wall during the compressor operation will (when the compressor has cycled off) defrost automatically. Defrosted water collects inside the drain by passing through the drain outlet in the inner back wall into a drain pan situated above the compressor. From there, the water should evaporate over time.

CLEANING THE UNIT

CAUTION: Do not use boiling water because it may damage the plastic parts. In addition, never use a sharp or metallic instrument to remove frost as it may damage the cooling system and will void the warranty. We recommend using a plastic scraper.

- 1) Turn the temperature control to "OFF", unplug the unit and remove the food, shelves, and tray.
- 2) Wash the inside surfaces with warm water and baking soda solution. The solution should be about 2 tablespoons of baking soda to a quart of water.
- 3) Wash the shelf and tray with a mild detergent solution.
- 4) The outside of the unit should be cleaned with mild detergent and warm water. Rinse well and wipe dry with a clean, soft cloth.
- 5) Wring excess water out of the sponge or cloth before cleaning the area of the controls or any electrical parts.

POWER FAILURE

Most power failures are corrected within a few hours and should not affect the temperature of your unit if you minimize the number of times the door is opened. If the power is going to be off for a longer period, you need to take the proper steps to protect your food.

VACATION TIME

- 1) Short vacations: Leave the unit operating during vacations of less than three weeks.
- 2) Long vacations: If the appliance will not be used for several months, remove all food, and unplug the power cord. Clean and dry the interior thoroughly. To prevent odor and mold growth, leave the door open slightly, blocking it open if necessary.

MOVING YOUR UNIT

- 1) Remove all the food.
- 2) Securely tape down all loose items inside your unit.
- 3) Tape the door shut.
- 4) Be sure the unit stays secure in the upright position during transportation. Also protect the outside of the unit with a blanket or similar item.

ENERGY SAVING TIPS

- 1) Let hot foods cool to room temperature before placing in the unit. Overloading the unit forces the compressor to run longer.
- 2) Be sure to wrap food properly and wipe containers dry before placing them in the unit. This cuts down on frost build-up inside the unit.
- 3) Unit storage bin should not be lined with aluminum foil, wax paper, or paper towels. Liners interfere with cold air circulation, making the unit less efficient.
- 4) Organize and label food to reduce door openings and extended searches. Remove as many items as needed at one time and close the door as soon as possible.



TROUBLESHOOTING

| SYMPTOM | POSSIBLE CAUSE |
|--|--|
| Unit does not operate. | Not plugged in. |
| | The circuit breaker tripped or a blown fuse. |
| | The unit temperature control is set at "OFF" position. |
| Turns on and off frequently. | The room temperature is hotter than normal. |
| | A large amount of food has been added to the unit. |
| | The door is open too often. |
| | The door is not closed completely. |
| | The temperature control is not set correctly. |
| | The door gasket does not seal properly. |
| | The unit does not have the correct clearances. |
| Vibrations. | Check to assure that the unit is level. |
| The unit seems to make too much noise. | The rattling noise may come from the flow of the refrigerant, which is normal. |
| | As each cycle ends, you may hear gurgling sounds caused by the flow of refrigerant in your unit. |
| | Contraction and expansion of the inside walls may cause popping and crackling noises. |
| | The unit is not level. |
| The door will not close properly. | The unit is not level. |
| | The door was reversed and not properly installed. |
| | The gasket is dirty or bent. |
| | The shelves, bins or baskets are out of position. |



REGISTERING YOUR REFRIGERATOR

Thank you for purchasing your Bull Outdoor Products Refrigerator. To validate your Limited Warranty, you must submit the completed the Warranty Registration Form within 90 days from the date of purchase. Registration can be completed on-line at

<https://bullbbq.com/register>

or by sending the completed Warranty Registration Form and copy of your Purchase Receipt or Invoice as proof of purchase to:

BULL OUTDOOR PRODUCTS, INC.
1011 East Pine St.
Lodi, CA 95240
Attn: Warranty Service Center

For Warranty Claims or Replacement Parts ordering, please fill out the area provided below:

PRODUCT INFORMATION REFERENCE CARD

1) Model Number _____

2) Serial Number _____

(The Serial Number is encoded with essential information for ordering replacement parts or submitting Warranty claims. Location of Serial Numbers is shown below)

3) Date of Purchase _____

4) Copy of your Purchase Receipt or *Invoice*.

For Warranty Questions call Customer Service at (800) 521-2855

LOCATION OF SERIAL NUMBER

Essential information about your product is encoded in the serial number. This information will be required for all warranty claims, ordering replacement parts and will identify any variations of your unit. It is extremely important that you record your serial number and register your grill from the Proof of Purchase.



Select Contemporary Refrigerator

FRONT



THIS SIDE UP

- Space Saving Design
- Stainless Steel Door
- Reversible Door-
Left or Right Swing
- Full Range Temperature Control
- Beverage Dispenser.
Holds Seven 12 OZ Cans
- Net Weight
62lbs
- Unit Dimensions:
32½"H x 20"W x 20½"D







CONFORMS TO UL STD. 60335-1 &
60335-2-24 & CERTIFIED TO CSA STD.
C22.2 No. 60335-1 & 60335-2-24

MADE IN CHINA

The shipping box has the serial number printed on the Front and Back of shipping box as shown.



MODEL: 11520



CONFORMS TO
UL STD. 60335-1
& 60335-2-24 &
CERTIFIED TO
CSA STD. C22.2
No. 60335-1 &
60335-2-24

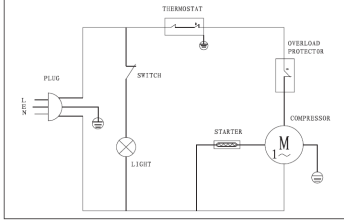

MADE IN CHINA

| SPECIFICATIONS | |
|-----------------|----------|
| DESIGN PRESSURE | |
| HIGH SIDE | 110 PsiG |
| LOW SIDE | 70 PsiG |
| REFRIGERANT | R600a |
| AMOUNT | 0.7 Oz |
| RATED VOLTAGE | 115V AC |
| RATED FREQUENCY | 60 Hz |
| RATED CURRENT | 0.75 A |
| POWER INPUT | 55 W |
| LED LAMP POWER | MAX.2 W |
| NET WEIGHT | 62 LBS |
| MANUFACTURED | |

Data plate on the back of the unit shows the serial number.

INSPECT YOUR REFRIGERATOR FOR ANY DAMAGE AND CONTACT OUR SERVICE CENTER OR LOCAL DEALER FOR REPLACEMENT OF ANY DAMAGED PARTS. IF DAMAGED DO NOT ATTEMPT INSTALLATION.

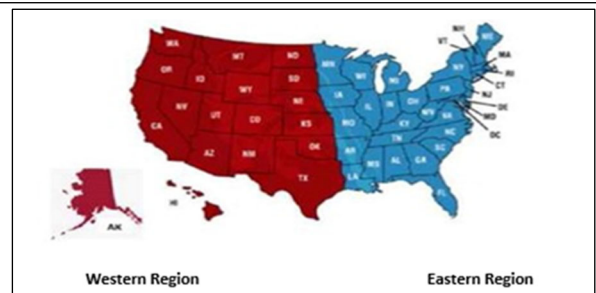

HOW TO ORDER REPLACEMENT PARTS

This is where your Product Information Reference Card will come in handy for supplying the Model # and Serial #. needed by your Bull Authorized Dealer to assure you get the correct part(s) or additional accessories to keep your Refrigerator in top working condition. If you don't have the card you can still get the model number and type of gas hook up used as stated on your Refrigerator data sticker as shown in the caption above.

Please refer to your owner's manual parts list and illustration to identify what you need.

To Order Replacement Parts on-line go to: <https://bullbbq.com/partsearch>

Ordering Parts Western Region Customers, please call **(800) 258-6810 by phone:** Eastern Region Customers, please call **(760) 291-8469**

Bull is ready to help with 2 regional suppliers open 8:00 am to 5:00 pm Monday through Friday.

WARNING: Use of any part that is not factory authorized will void your warranty and may be dangerous.



**11520 REPLACEMENT PARTS LIST AND REFERENCE DRAWING
(WARRANTY PERIOD FOR ALL PARTS IS 1 YEAR)**

| # NO. USED IN PARTS LIST ILLUSTRATION | BULL PART NO. | PART DESCRIPTION | QTY |
|---------------------------------------|---------------|--|-----|
| 1 | 11504 | INTERIOR LIGHT COVER | 1 |
| 2 | 11500 | TEMPERATURE CONTROL KNOB | 1 |
| 3 | 11503 | SHELF (WIRE) | 2 |
| 4 | 11506 | SHELF (GLASS) | 1 |
| 5 | 11505 | DRAWER | 1 |
| 6 | 11508 | LEVELING LEG | 2 |
| 7 | 11507 | CAN DISPENSER | 1 |
| 8 | 11511 | CONDIMENT BAR | 1 |
| 9 | 11519 | DOOR | 1 |
| 10 | 11510 | DOOR BAR | 1 |
| 11 | 11517 | TOP AND BOTTOM HINGE (1 SET INCLUDES BOTH HINGES) | 1 |
| 12 | 11518 | DOOR HINGE COVER | 1 |

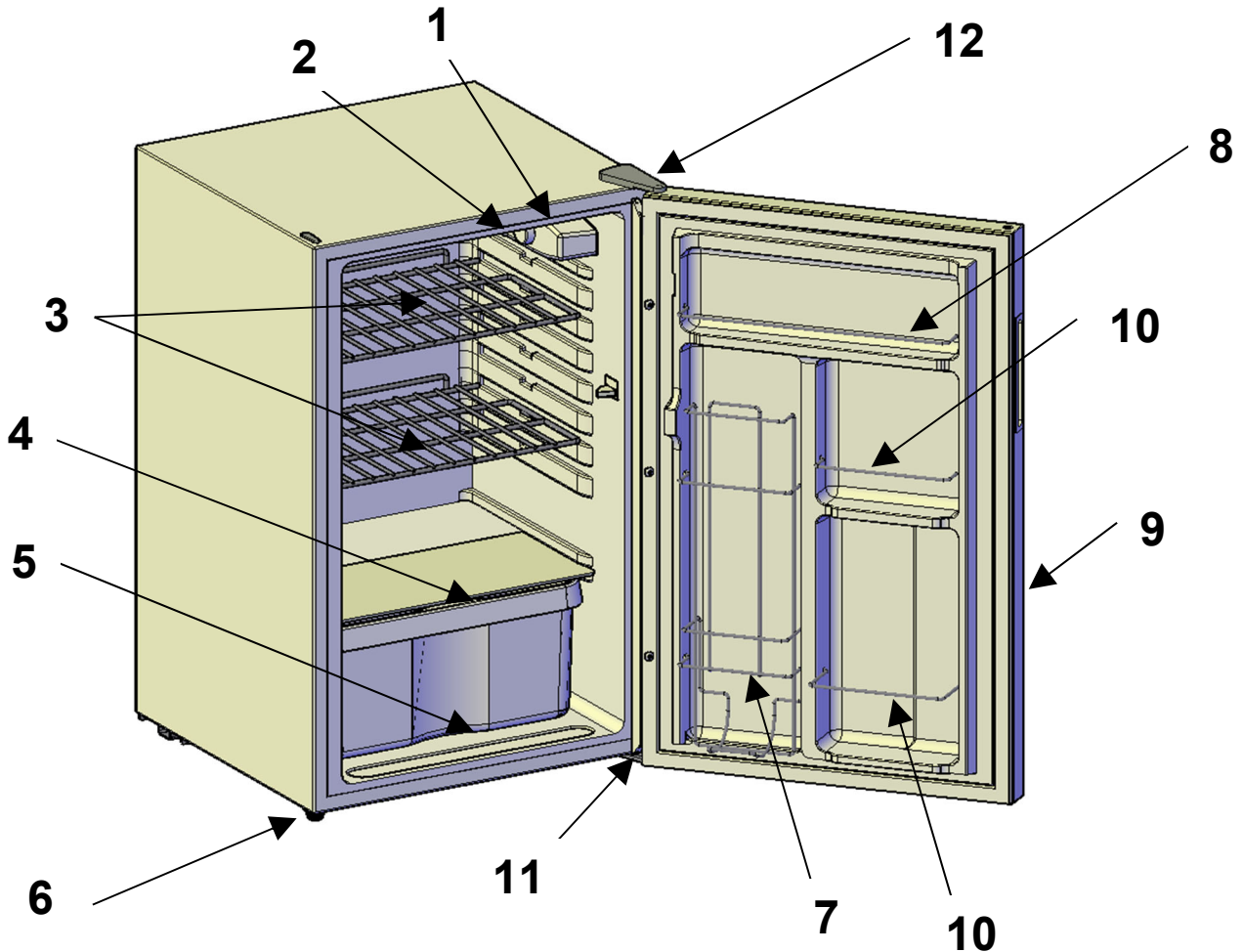

WARNING: Use of any part that is not factory authorized will void your warranty and may be dangerous.



Warranty Policy

LIMITED WARRANTY ON BULL OUTDOOR PRODUCTS, INC., PRODUCTS

THIS LIMITED WARRANTY GIVES YOU SPECIFIC LEGAL RIGHTS. YOU MAY ALSO HAVE OTHER RIGHTS, WHICH VARY FROM STATE TO STATE.

THIS LIMITED WARRANTY CAN ALSO BE FOUND ON OUR WEB SITE AT:

<https://www.bullbbq.com/support-warranty> (United States Customers);

<https://www.bullbbq.eu/en/warrantyform.htm> (International Customers)

AND IN THE OWNER'S/INSTALLATION MANUAL THAT WE PROVIDE WITH OUR PRODUCT.

THIS LIMITED WARRANTY IS SUBJECT TO THE EXCLUSIONS, CONDITIONS AND LIMITATIONS SET FORTH BELOW.

ANY IMPLIED WARRANTIES IMPOSED BY LAW, INCLUDING WITHOUT LIMITATION THE IMPLIED WARRANTIES OF MERCHANTABILITY AND FITNESS FOR A PARTICULAR PURPOSE, ARE LIMITED IN DURATION TO THE DURATION OF THIS EXPRESS LIMITED WARRANTY. SOME STATES DO NOT ALLOW LIMITATIONS ON HOW LONG AN IMPLIED WARRANTY LASTS, SO THE ABOVE LIMITATION MAY NOT APPLY TO YOU.

WHO MAY USE THIS WARRANTY?

BULL OUTDOOR PRODUCTS, INC. located at address 1011 East Pine St. Lodi, CA. 95240

("we") extend this limited warranty only to the consumer who originally purchased the product ("you") at the original site of delivery or installation. It does not extend to any subsequent owner or other transferee of the product. It does not apply to products installed in any rental, commercial or non-residential application. Examples of excluded applications include, but are not limited to day care centers, schools, bed and breakfast centers, churches, private clubs, fire stations, club houses, common areas in multi-family dwellings, restaurants, hotels, nursing homes, food service locations and institutional food service locations.

WHAT DOES THIS WARRANTY COVER?

This limited warranty covers defects in materials and workmanship of the product and product components identified below for the Warranty Periods defined below.

WHAT IS THE PERIOD OF COVERAGE?

This limited warranty starts on the date of your purchase and lasts for the time period or time periods specified above (the "**Warranty Period**"). The Warranty Period is not extended if we repair or replace the product. We may change the availability of this limited warranty at our discretion, but any changes will not be retroactive.



Warranty Policy (Continued)

- **Grill Warranty Periods**

The following parts are covered for **one year** on all our current gas grill models:

The lid, control panel, grease tray, bezels, knobs, temperature gauge, valves, regulator, flex tubes, rotisserie burner, transformer, and all components of the lighting system.

The following parts are covered for **three years** on all our current gas grill models:

The manifold, handle end caps, flame tamers, heat shields, and warming rack.

The following parts are covered for **lifetime** on all our current gas grill models:

Insert assembly and the grates.

The warranty period for the grill burners vary by type:

Cast stainless steel burners - **lifetime**,

Welded burners – **5 years**, and

Porcelain coated burners – **3 years**.

The warranty period for the charcoal grill is **one year** on all parts, except for the insert assembly, which is covered for **5 years**.

The Bel Air grill included a **one-year** warranty on all parts.

- **Component Warranty Periods**

All of the parts for our components/grill carts/refrigerators/kegerators/drawers/doors are covered for **one year** with these exceptions:

Power Burner

- The insert/grates are **lifetime** covered parts.
- The manifold/burner are covered for **3 years**.

Searing Station/Slide in Double Sideburner

- The grates are covered for **lifetime**,
- the insert for **5 years**, and
- the manifold for **3 years**.

Single Sideburner

- The grates are covered for **5 years** and
- the burner for **3 years**.

Sidekick

- The burner is covered for **3 years**.

- **Pizza Ovens/Islands/Fire Features Warranty Periods**

All of the parts and construction materials are covered for **one year**.

Grill Accessories and Grill Covers do not include a warranty period.



Warranty Policy (Continued)

WHAT DOES THIS WARRANTY NOT COVER?

This limited warranty does not cover any damage due to: (a) transportation; (b) storage; (c) improper installation or use; (d) use on improper fuel/gas supply; (e) failure to follow the product instructions or to perform any preventive maintenance; (f) modifications; (g) unauthorized repair; (h) normal wear and tear; or (i) external causes such as accidents, abuse, or other actions or events beyond our reasonable control.

WHAT ARE YOUR REMEDIES UNDER THIS WARRANTY?

With respect to any defective product claim made during the Warranty Period, we will, in our sole discretion, either: repair or replace such product (or the defective part) free of charge or (b) refund the purchase price of such product. We will not pay for shipping charges for repaired or replacement parts, or for any labor or labor related charges. We will not pay for any accessory products or ancillary products purchased by you for use in connection with the product.

HOW DO YOU OBTAIN WARRANTY SERVICE?

To obtain warranty service, you must submit a warranty claim online through the Bullbq.com website during the Warranty Period. Warranty claims will not be accepted via email, fax or phone.

LIMITATION OF LIABILITY

THE REMEDIES DESCRIBED ABOVE ARE YOUR SOLE AND EXCLUSIVE REMEDIES AND OUR ENTIRE LIABILITY FOR ANY BREACH OF THIS LIMITED WARRANTY. OUR LIABILITY SHALL UNDER NO CIRCUMSTANCES EXCEED THE ACTUAL AMOUNT PAID BY YOU FOR THE DEFECTIVE PRODUCT, NOR SHALL WE UNDER ANY CIRCUMSTANCES BE LIABLE FOR ANY CONSEQUENTIAL, INCIDENTAL, SPECIAL OR PUNITIVE DAMAGES OR LOSSES, WHETHER DIRECT OR INDIRECT. SOME STATES DO NOT ALLOW THE EXCLUSION OR LIMITATION OF INCIDENTAL OR CONSEQUENTIAL DAMAGES, SO THE ABOVE LIMITATION OR EXCLUSION MAY NOT APPLY TO YOU.

Revised 10-15-2020 APR